

### LOCATION

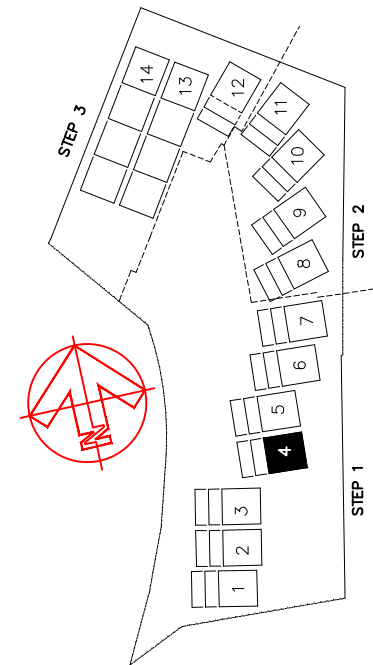

### AREAS

Interior	2,175.19 sqf
Total outside Living	1,118.06 sqf
Covered Terrace	813.85 sqf
Gated Private Terrace	304.21 sqf
Parking (1)	213.13 sqf
<b>Total Square Footage</b>	<b>3,506.38 sqf</b>

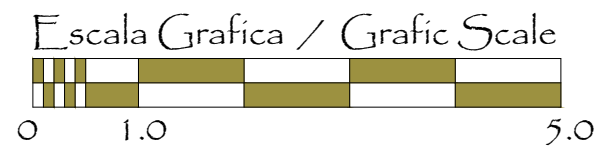

# PLAYA de LA PAZ

Residence 304

2 bedrooms

3rd Level

